

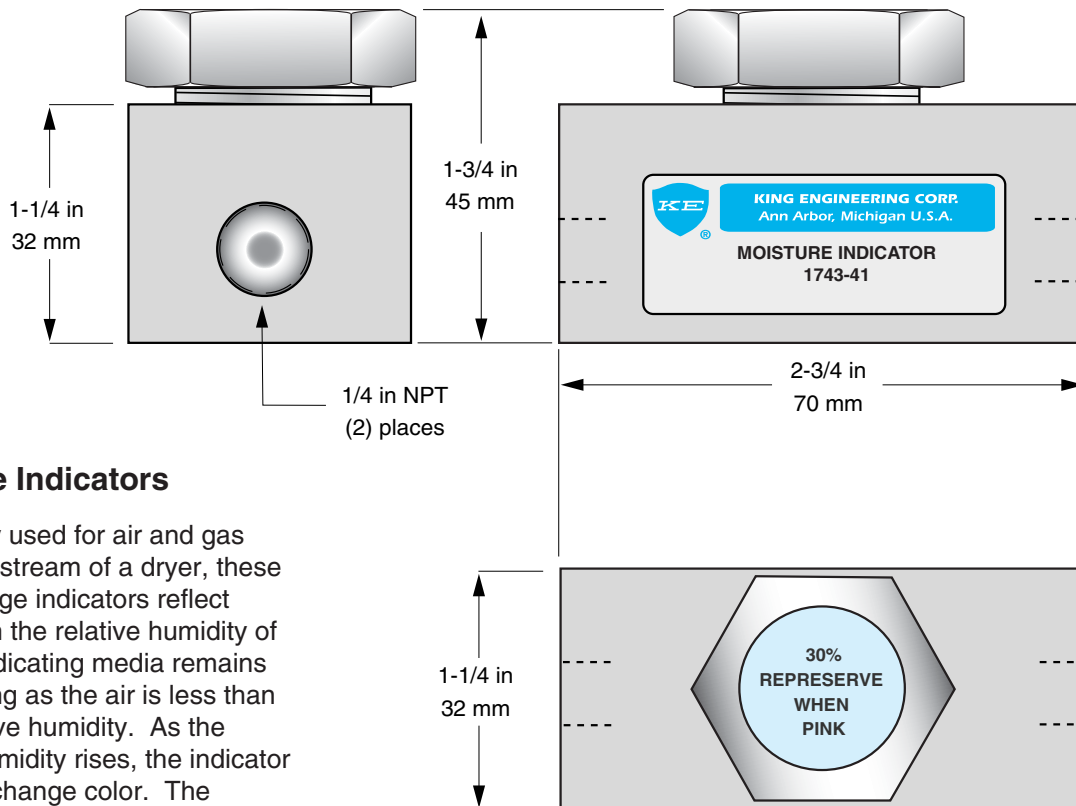

Effective: February, 2004 (replaces Feb, 1998)

# Air Line Moisture Indicator Model 1743-41



## Moisture Indicators

Commonly used for air and gas lines downstream of a dryer, these color-change indicators reflect changes in the relative humidity of the air. Indicating media remains blue as long as the air is less than 20% relative humidity. As the relative humidity rises, the indicator begins to change color. The indicator will be pink in appearance as relative humidity level approaches 40%.

The indicator will quickly change back to blue when in contact with air of less than 20% relative humidity (such as after a new desiccant charge is installed in the upstream dryer).

**Model Number:**  
1743-41

**Connections/Mounting:**  
1/4" NPT, In Line Mounting

**Physical Data:**  
Housing - Aluminum  
Weight - 1 lb.

## Discontinued Part Numbers:

1743-42 ..... 3/8" NPT ..... In-Line Mtg.  
1743-43 ..... 1/4" NPT ..... Flush Mtg.  
1743-44 ..... 3/8" NPT ..... Flush Mtg.



**REPLACEMENT NOTE:**

Indicator plug will revert to blue color after extended exposure to air (or environment) of 20% relative humidity (RH) or less. Under normal use, the internal indicator disc can retain its performance for many years.

However, contamination by oil vapor or excessive wetting of internal indicator disc will degrade performance and may warrant replacement of the Indicator Plug.

**To replace Indicator Plug:**

1. Unthread plug from inline body.
2. Install new replacement plug and tighten adequately. (Sealant or teflon tape may be used to ensure leak-tight fit.)

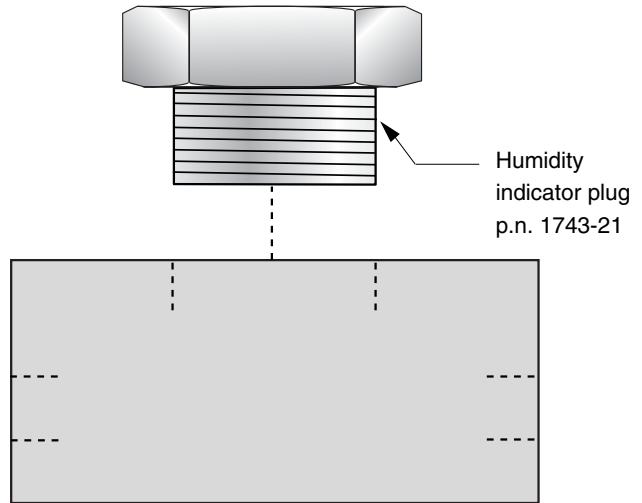

**SERVICE/REPLACEMENT PART**

| Description             | Part No. | Qty. |
|-------------------------|----------|------|
| Indicator Plug Assembly | 1743-21  | 1    |

© King-Gage and the KE emblem are registered trademarks of King Engineering Corporation, Ann Arbor, Michigan, U.S.A.

All specifications are subject to change without notice

© 2004 King Engineering Corporation. All rights reserved