

# ultra-c filter

FOR ULTRA CLEAN COMPRESSED AIR

## MODEL U800

## 80 SCFM

<b>Maximum—</b>	
Flow Rate @ 100 PSIG (7 Kg/Cm <sup>2</sup> ) (see note below)	80 SCFM (2240 NL/Min)
Inlet Pressure	150 PSIG (10.5 Kg/Cm <sup>2</sup> )
Temperature	120°F (49°C)
<b>Contaminant Particle Removal. . . .</b>	
Solids	All particles one micron or larger
Liquids	99.99% of all particles (aerosols) one micron or larger
<b>Normal Pressure Loss @ maximum allowable flow rate</b>	
Cartridge—(New Condition)	Less than 1.5 psi (.11 Kg/Cm <sup>2</sup> )
Cartridge—(Saturated with Liquid)	Less than 4 psi (.28 Kg/Cm <sup>2</sup> )
<b>Materials—</b>	
Sump	Aluminum
Body	Aluminum
Connections	1" NPT
<p>Note: To determine maximum allowable flow rate for inlet pressure other than 100 PSIG, use the following formula:            Maximum Allowable Flow Rate = .7P + 10            where P = Inlet Pressure (PSIG).            Mounting Bracket (Part No. U3408) available as an accessory.            Replacement Cartridge (Part No. U3004).</p>	

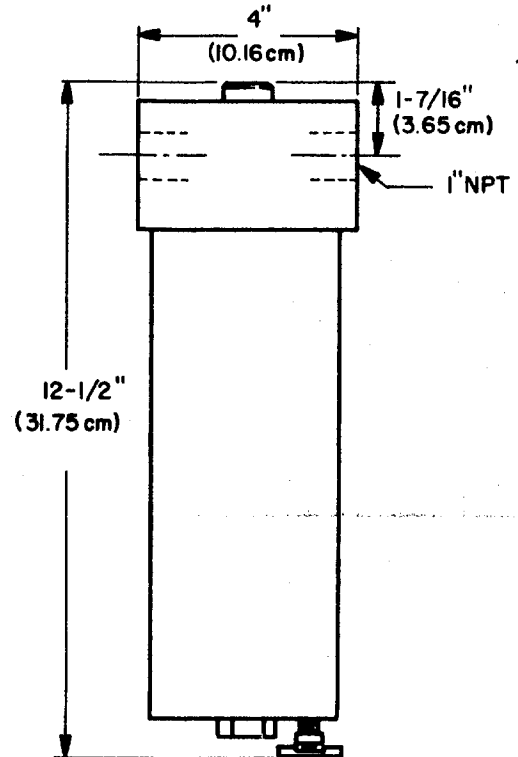

## INSTALLATION

The Ultra-C Filter may be installed in any compressed air or inert gas line when the pressure will not exceed 150 psig (10.5 Kg/Cm<sup>2</sup>) and when flow rate & temperature will not exceed those defined in the specification table above.

The Ultra-C Filter is intended for mounting directly into or at the end of a rigid pipeline and no mounting bracket is required. However, when the filter is to be connected with metal or plastic tubing or hose, a mounting bracket is available. (See specification table above.)

When installing the filter—

1. Make certain the flow is in the direction indicated on the nameplate.
2. Locate as near to the end use as practical.
3. Locate downstream of pressure regulators or reducing valves when flow rate permits.
4. Locate where the sump is accessible for inspection and draining as necessary.

Y3030-21

**King**  
 ENGINEERING CORPORATION  
 Box 1228 Ann Arbor, Michigan 48106

OVER →

U-100-800

# ultra-c™ filter

FOR ULTRA CLEAN COMPRESSED AIR

## SERVICE PARTS

### OPERATION

Under normal operating conditions the only service required is to drain liquid from the sump and to change cartridge—

The sump must be drained regularly. Failure to drain can result in permanent damage to the equipment downstream of the filter. A regular schedule for draining should be established as experience dictates. Remember, the quantity of liquid trapped in the sump will increase during periods of high humidity. —When cleaning the sump use soap and water only. Do NOT use strong detergents or solvent base cleaning solutions.

Change the cartridge when pressure drop reaches 15 psi or sooner if pressure drop is objectionable.

Replacement  
Cartridge Assy.  
U3004

O-Ring  
U-6495-556

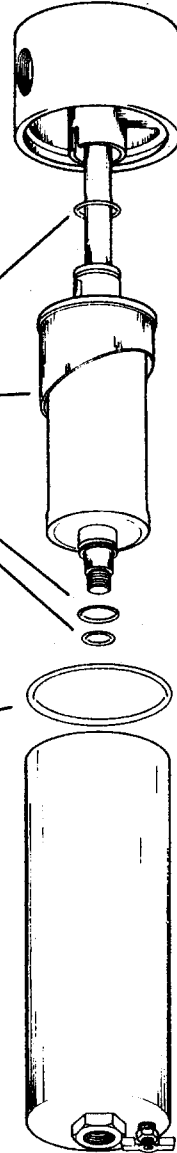

#### GUARANTEE

All King Engineering products are guaranteed to be free from defects in material and workmanship, and to provide the service for which they are intended. Any part found defective under normal use within one year from date of purchase will be repaired or replaced at no charge if returned to the factory in Ann Arbor.

 **King**  
ENGINEERING CORPORATION  
Box 1228 Ann Arbor, Michigan 48106

OVER →