

Service Parts & Dimensions – 1020-1.20

Effective: Sept, 2005 (replaces June, 2002)

Model 868 D/P Sensor Control

Part Number Reference:

868 - 9 - 1 8

Fittings:
1 - none
3 - Polyflo
4 - Hi Duty

D/P Nominal Range:
0 - 5 psid
1 - 10 psid
2 - 15 psid
3 - 30 psid
4 - 50 psid

Fitting Reference:

P..... Air Purge
V..... Vent
CA..... Compressed Air
S..... Signal Pressure
E..... Equalizer Reference

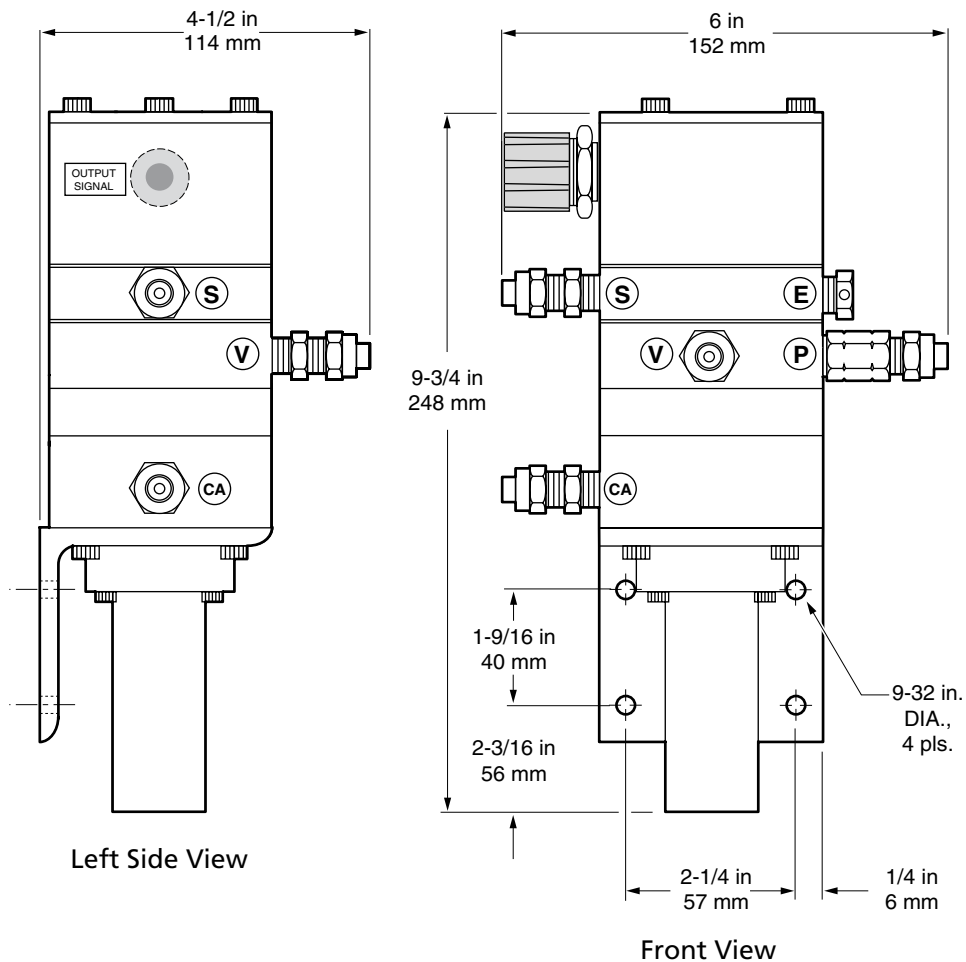

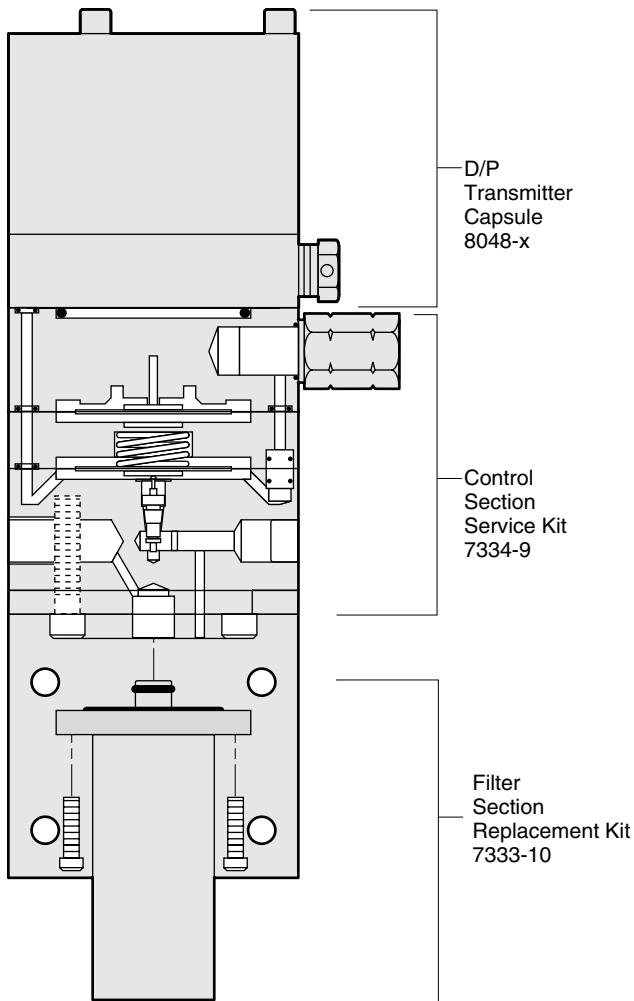

Purge Control Section Service Kit 7334-9

Description	Part No.	Qty.
Replacement Valve Kit.....	3257-1	1
Orifice Assembly	4527-2	1
Diaphragm Assembly	4508-6	1
Spring (long)	6927-7	1
Diaphragm Assembly	4508-7	1
(w/ rubber seat)		
Spring (short)	6927-6	1
O-Ring	6495-559	5

Filter Section Replacement Kit 7333-10

Description	Part No.	Qty.
Filter w/ O-Rings	7333-10	1

© King-Gage and the KE emblem are registered trademarks of King Engineering Corporation, Ann Arbor, Michigan, U.S.A.

All specifications are subject to change without notice

© 2005 King Engineering Corporation. All rights reserved